



WASHING MACHINE OWNER'S MANUAL

- Before using your washing machine, please read this manual carefully and keep it for future reference.
- The drawings in this manual are for instruction only, it may vary from the model you buy.

Contents

Products Specification.....	2
Safety Precaution.....	3
Important Hints.....	5
Overview of Washing Machine.....	6
Install Washing Machine.....	7
Maintenance.....	11
Operate Washing Machine.....	14
Troubleshooting.....	25
Appendix.....	27
Products Fiche.....	29

Products Specification

Parameter	Inverter Motor Series
Model	DWD85
Washing Capacity	8.0kg
Drying Capacity	5.0kg
Voltage	220-240V~/50Hz
Rated Power	2000W
Water Pressure	0.05-0.8MPa
Outer Dimension (W*D*H)mm	595*560*850
water consumption of warm wash	81L

NOTE:

1. All the pictures in the manual are used for schematic only. It may be different from the machine you buy.
2. The actual function and the data in kind prevail.

WARNING

To reduce the risk of fire, electric shock, or injury to persons when using your appliance, follow basic precautions, including the following

- If the power cord is damaged, it must be replaced by the manufacturer, service agent or similarly qualified persons in order to avoid the hazard.
- The new hose-sets supplied with the washer are to be used and that old hose-sets should not be reused.
- This appliance is not intended for use by persons (including children) with reduced physical, sensory or mental capabilities, or lack of experience and knowledge, unless they have been given supervision or instruction concerning use of the appliance by a person responsible for their safety. Children should be supervised to ensure that they do not play with the appliance. (This warning is not for EUROPEAN market)
- This appliance can be used by children aged from 8 years and above and persons with reduced physical, sensory or mental capabilities or lack of experience and knowledge if they have been given supervision or instruction concerning use of the appliance in a safe way and understand the hazards involved. Children shall not play with the appliance. Cleaning and user maintenance shall not be made by children without supervision. (This warning is for EUROPEAN market)
- Carpet does not obstruct the opening for washing machine with ventilation openings in the base.
- Children of less than 3 years should be kept away unless continuously supervised.
- This appliance is intended to be used in household and similar applications such as:
 - staff kitchen areas in shops, offices and other working environments;
 - farm houses
 - by clients in hotels, motels and other residential type environments;
 - bed and breakfast type environments;
 - areas for communal use in blocks of flats or launderettes.
- Take care that power voltage and frequency shall be identical to those of washing machine.
- To ensure your safety, power cord plug must be inserted into an earthed socket. Check carefully and make sure that your socket is proper and earthed reliably.
- Do not use any socket with rated current less than that of washing machine.
- Do not operate your washer when parts are missed or broken.
- Never pull out power plug with wet hands.

Safety precaution

- Replace immediately worn power cord, loose plugs/power sockets.
 - Unplug your washer before cleaning or making any repair.
- Please check whether the water inside the drum has been drained before opening the door. Please do not open the door if there is any water visible.
- Glass door may be very hot during the operation. Keep kids and pets far away from the washer during the operation.
 - Make sure that the water and electrical device must be connected by a qualified technician in accordance with the manufacturer's instruction and local safety regulations.
 - Before operating this machine, all packages and transit bolts must be removed. Otherwise, the washing machine may be seriously damaged while washing the clothes.
 - Flammable and explosive or toxic solvents are forbidden. Gasoline and alcohol etc. Shall not be used as detergents. Please only select the detergents suitable for machine washing.
 - Be careful of scald while the washer draining hot washing water.
 - Never unplug your washer by pulling on the supply cord. Always grasp the plug firmly and pull straight out from the outlet.
 - If your old appliance is not being used anymore, we recommend that you remove the door and cut off the supply cord.
 - Packing materials may be dangerous to the kids. Please keep all packing materials (plastic bags, foams etc) far away from the kids.
 - Do not climb up and sit on top cover of the machine.
 - Pets and kids may climb into the machine. Check the machine before every operation.
 - Do not lean against the door of the washer.
 - The appliance must not be installed behind a lockable door, a sliding door or a door with a hinge on the opposite side to that of the tumble dryer, in such a way that a full opening of the tumble dryer door is restricted.
 - Do not dry unwashed items in the tumble dryer (IEC 60335-2-11).



Symbol ISO
7010 W021

Warning; Risk of fire /
Flammable materials

Oil-affected items can ignite spontaneously, especially when exposed to heat sources such as in a tumble dryer. The items become warm, causing an oxidation reaction in the oil. Oxidation creates heat. If the heat cannot escape, the items can become hot enough to catch fire. Piling, stacking or storing oil-affected items can prevent heat from escaping and so create a fire hazard.

If it is unavoidable that fabrics that contain vegetable or cooking oil or have been contaminated by hair care products be placed in a tumble dryer they should first be washed in hot water with extra detergent -this will reduce, but not eliminate, the hazard.

Important Hints

- The household washing machine isn't intended to be built-in.
- This washing machine is for indoor using only.
- Make sure that all pockets are empty. Sharp and rigid items such as coin, brooch, nail, screw or stone etc. May cause serious damages to the washer.
- Please remember to disconnect water and power supply immediately after the clothes are washed.
- The washing machine shall not be installed in bath room or very wet rooms as well as in the rooms with explosive or caustic gases.
- Before washing the clothes at first time, the washing machine shall be operated in one round of the whole procedures without the clothes inside.
- Do not repair or replace any part of the washer unless you have been specifically recommended in the user-repair instructions and you have the knowledge and skills to make it.
- It is forbidden to wash carpets and bras inset with steel wire.
- Never refill water by hand during washing.
- After the program is completed, please wait for two minutes to open the door.
- When handing the machine, the accumulated water shall be drained out of the machine firstly. Handle the machine carefully. Never hold each protruded part on the machine while lifting. Machine door can not be used as the handle during the conveyance.
- The washing machine with single inlet valve only can be connected to the cold water supply. The washing machine with double inlet valves can be connected to the hot water and cold water supply.

Overview of Washing Machine

Every machine has passed comprehensive ex-factory inspection to ensure complete functions and optimal operating state;
Please read this Manual carefully before using the machine. Please properly keep Instruction Manual in case of future need;
All figures in this Manual are structural diagrams and your purchased product is subject to actual product model.

■ Remove transit bolts

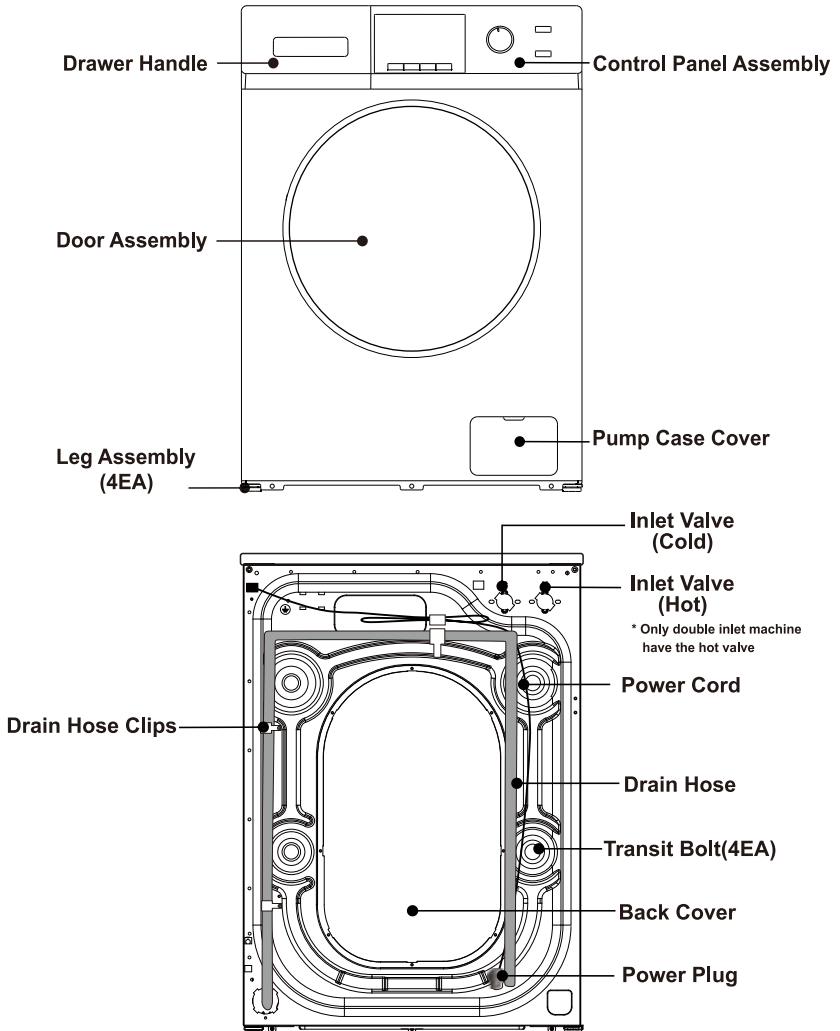

Install Washing Machine

NOTE

We recommend that your new washer should be installed by a qualified appliance technician. If you feel that you have the skills to install the washer, please read the installation instructions carefully before installing.

■ Tools needed





You may need to have the following tools to help you in the installation of your washer:

- Scissors
- Pliers
- Standard Screwdriver
- Gloves
- Spanner

■ Unpacking the washing machine

Unpacking your washing machine and check if there is any damage during the transportation. Also make sure that all the items (as shown below) in the attached bag are received. If there is any damage to the washing machine during the transportation, or any item is missing or damaged, please contact the local dealer immediately.

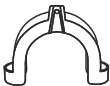
***If washing machine is not double inlet, the machine does not have the hot inlet hose.**

Inlet Hose (Connect to cold water supply)	Hot Inlet Hose (Connect to Hot water supply)	Hole Cover (4EA) (Used to plug transit bolt holes)	Drain Hose Support Bracket (Used to loop the end of drain hose)	Spanner (1. Used to adjust the bottom of the machine, 2. Remove the transport bolt on the back of the machine)
				

■ Select the location

Before installing the washer, the location characterized as follows shall be selected:

- Rigid, dry, and level surface (if not level, please make it level with reference to the following figure "Adjustable Leg").
- Avoid direct sun light.
- Sufficient ventilation.
- The ambient temperature shall be between 0-40°C.
- The ambient humidity shall be below 95% (When the temperature is 25°C).
- Keep far away from the heat resources such as coal or gas. Make sure that the washer will not stand on power cord. Do not install the washer on the carpet floor.

Install Washing Machine

■ Remove transit bolts

Before using this washing machine, transit bolts must be removed from the backside of this machine. Please take the following steps to remove the bolts:

⚠ Keep the transit bolts properly for further use.

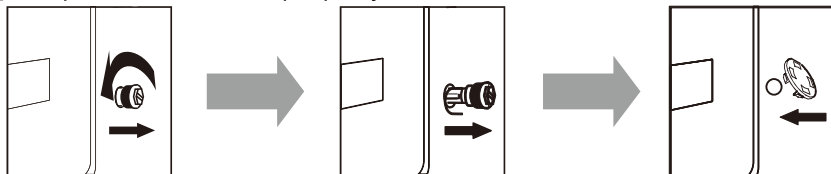

1. Loosen the four transit bolts with a spanner

2. Take each bolt head and pull it through the wide part of the hole. Repeat for each bolt.

3. Fill the holes with the supplied plastic covers.

■ Level the washing machine

Install or place the washing machine under the environmental temperature of not less than 0°C but not outdoors, for it may damage the programming controller.

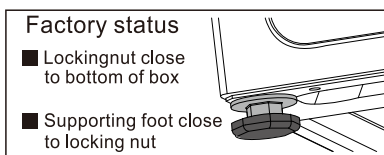
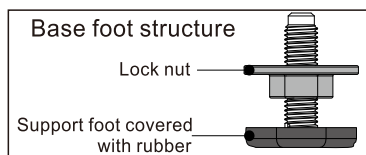

⚠ **Note:** In order to facilitate installation, the factory status of the foot may not be all locked, please be sure to lock all four feet before adjusting the level

1. When placing the machine, check whether the bottom foot is in the factory state. If not, please restore the bottom foot to the factory state: the locking nut is locked tightly on bottom of the box, and the support foot is locked tightly on the locking nut.

2. After the machine is placed, press the opposite corner of the top cover plate of the washing machine with both hands to turn and shake it vertically downward to check whether the supporting foot is close to the ground and whether the machine is shaken.

3. To ensure that the machine is placed in the right state, loosen the locking nut according to the direction shown in the diagram with the attached spanner to the appropriate height until the supporting foot is close to the ground and the machine is free from shaking.

4. Finally, use the spanner to turn the lock nut back to the bottom of the box to lock it (you can also slightly fix the support foot by hand to avoid the support foot moving again).

⚠ CAUTION

1. The machine must be perfectly leveled and stabilized when the four supporting feet are close to the ground. Lower the feet as much as possible on the basis that the machine is leveled.

2. Improper leveling adjustment may cause loud noise, machine vibrating, machine displacement and other abnormal phenomena.

3. Air-vent is designed on the bottom of the machine (prevent blockage). Install the washing machine on solid, smooth and skid-proof ground. Do not place the washing machine on soft blanket or wooden floor, or various desktops and stands, in case of unnecessary injury.

Install Washing Machine

■ Connect the inlet hose

1. Connect the inlet hose to tap and fasten it anticlockwise.

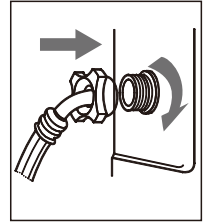
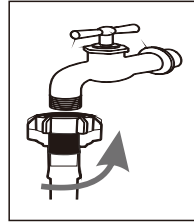

2. Connect the other end of the inlet hose to the inlet valve at the backside of the washing machine and fasten the hose tightly clockwise.

When there is an inlet at the back of the machine, it must be connected to a cold water supply. If there are two inlet valves, one is connected to a cold water supply and the other is connected to a hot water supply. Follow the indication of the picture below to complete the connection.

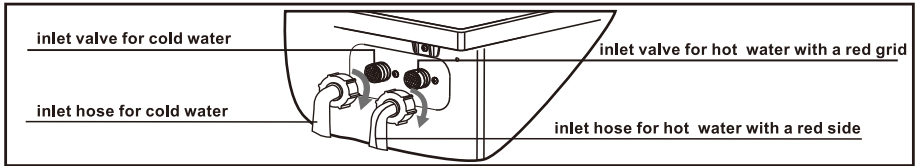

⚠ NOTE

- If there is any leakage with hose after the connection, then repeat the steps to connect inlet hose.
- Do not bend the hose.
- Check for inlet hose connection carefully before using the washer each time.

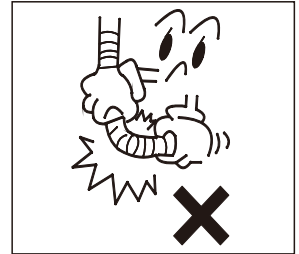

■ Connect the drain hose

- The drain hose shall be placed at a height of 65-100cm above the floor, otherwise, it can cause poor drainage.
- You can use the supplied drain hose support bracket to loop the drain hose down into the wall, standpipe or laundry tub.
- Take care to ensure all hose connections are tight.

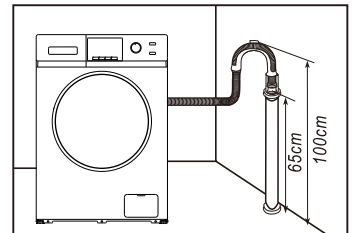
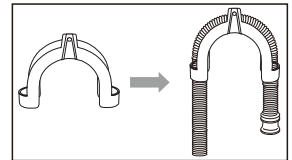

⚠ NOTE

- The end of the drain hose cannot be immersed in water for the washer to work properly.

Install Washing Machine

■ Connect the power

- As the maximum current through the unit is 10A when you are using its heating function, please make sure the power supply system (current, power voltage and wire) at your home can meet the normal loading requirements of the electrical appliances.
- Please connect the power to a socket which is correctly installed and properly earthed.
- Make sure the power voltage at your plate is same to that in the machine's rated voltage.
- Power plug must match the socket.
- Do not use multi-purpose plug or socket as extension cord.
- Do not connect and pull out plug with wet hands.
- When pulling out the plug, hold the plug tightly and then pull it out. Do not pull power cord forcibly.
- If power cord is damaged or has any sign of being broken, special power cord must be selected or purchased from its manufacturer or service center for replacement.

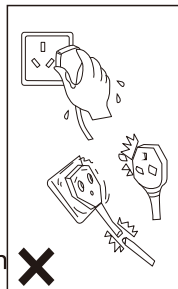

⚠ WARNING

1. This machine must be earthed properly. If there is any short circuit, earthing can reduce the danger of electrical shock.
2. Washing machine shall be operated in a circuit separate from other electrical appliances. Otherwise, power protector may be tripped or fuse may be burned out.

Maintenance

■ Serviceable range

- Your washing machine is designed for home use;
- Your washing machine can only wash machine-washable clothes;
- Your washing machine can only be connected to cold water tap, please select household low-foam detergent and care agent suitable for machine wash sold on the market;
- Steel wire lined in clothes will pop up during washing. In order to protect your machine and clothes, please do not wash clothes with steel wire in the machine;
- Cut off water and electricity every time after washing;
- The service environment conditions are as follows;
- Environment temperature: 4-40°C;
- Relative humidity: below 95% (at the temperature of 25°C);
- Keep pets away from the machine;
- Children or the elderly should use the machine with the company of a guardian;
- Install and use the machine in the room with floor drain;
- Do not wash carpets in the machine;
- Adopt Y connection to connect power cord and plug the power cord into a three pin socket with ground lead, and make sure the socket is grounded.



Notice: Beware of electric shock!

- Unplug power cord or cut off power before maintenance;
- Do not use chemical solution in case of explosion.

■ Clean exterior body and control panel

- Wipe with a soft and wet cloth;
- Do not use detergent with abradant
- Sweep away detergent residue immediately after leaning;
- Do not clean the machine by spraying water on it.

■ Clean interior drum

- Open the door and keep it dry;
- Rust: remove it with chloride-free detergent rather than a steel wire ball.

■ Clean detergent drawer

The structure of detergent case varies from different machine models; please follow steps and methods shown in below figure to clean the detergent case:

Maintenance

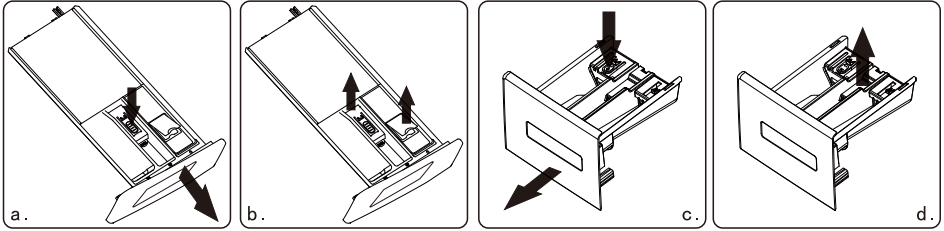

Auto dispenser

Common dispenser

■ If there is detergent or softener residue in the case:

- ◆ As fig. a(c) shows, pull the case and press down the limit rod; pull the whole drawer out;
 - ◆ As fig. b(d) shows, open the case (pick it up slowly) and take out syphon plate (lift it up);
 - ◆ Use tap water or brush to wash detergent case and syphon pipe;
 - ◆ Restore case cover and syphon pipe, and push the drawer in.
- A little detergent will flow into water box when drawing the case, this is normal.

Try not repeatedly opening and closing the case of detergent loss;

- Pay attention to the spillover of detergent that may cause inconvenience when adjusting (like tilting and moving, etc.) the machine (draw out the case before adjusting).

■ Recovery from freezing

The washing machine may freeze when it drops below 0°C.

1. Turn off the washing machine, and unplug the power cord.
2. Pour warm water over the water tap to loosen the water hose.
3. Disconnect the water hose, and soak it in warm water.
4. Pour warm water into the drum and leave it for about 10 minutes.
5. Reconnect the water hose to the water tap.

NOTE

1. When the washing machine is reused, make sure the ambient temperature is above 0°C.
2. If your washing machine is located in the room where it can get frozen easily, please drain the remaining water inside drain hose and inlet hose thoroughly.
3. Please contact a technician if your washer is frozen.

Maintenance



Caution: Beware of scald!

- Maintain the machine after the hot water is cooled in case of scald;
- Turn off the tap!

■ Outlet pump cleaning (twice a year is recommended)

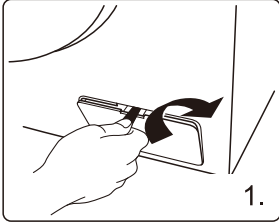

1. Tear down outlet pump protective cover with a blade or a coin as shown in the figure;

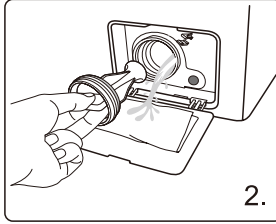

2. Unscrew the pump cover (beware of water residue) and take out clothes residue and clean it up completely until the blade can rotate freely;

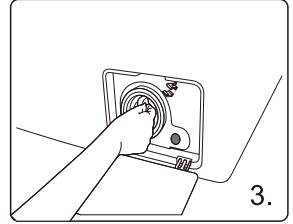

3. Fit on the pump cover and screw it to make sure there is no water leakage as shown in the figure. Put on the protective cover!

■ Inlet filter cleaning (twice a year is recommended)

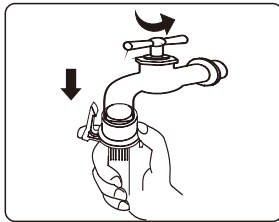

1. Turn off the tap, take apart the inlet hose and clean the filter with a brush;

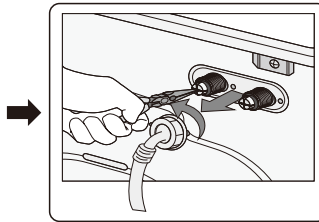

2. Unscrew the inlet hose in the back of the machine and pull out the filter with a nipper plier; restore it after cleaning;

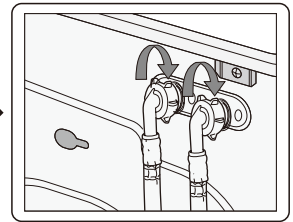

3. Reconnect it with inlet hose and turn on the tap to check if there is a leakage.

Operate Washing Machine

■ Preparation before using

International Textile Caring Label(ITCL) instruction: Labels on the textile assist you in choosing the best caring method!



Tumble Dry



Tumble Cool

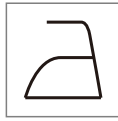

Ironing

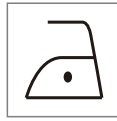

Cold Iron



Cold Bleach



No Tumble Dry



Hot Dry

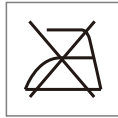

Do not Iron



Warm Iron



No Bleach



Warm Rinse

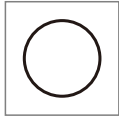

Dry Clean



Use Press Cloth



Hang Dry



Chemical Available



Do not Wash



Do not Dry



Do not Dry Clean



Put on Hanger



Hand Wash

■ Clothes sorting

- Do not exceed the rated washing capacity;
- Take out all foreign matters in the clothes, such as clip, coins and so on, in case of clothes and machine damage;
- Knot the tie, button up, zip up and sew the clothes. Put small items (like handkerchief, gloves, socks, etc.), twisted and wearable clothes into washing net before washing. The clothes in the net should not be more than 400g and be washed along with other clothes;
- Mix small clothes and big clothes together;
- Close the door and do not place the clothes between the door and sealing ring.

■ Put sorted clothes

- Sort clothes according to the washing information provided by manufacturer, such as washing labels, textile types, color and regulated washing temperature, etc.
- Check if the clothes color fades for the first time of washing;
- Do not put clothes into the machine for a long time, which may go moldy and produce spot. Please wash in time.
- Please wash clothes according to regulated temperature, otherwise it may cause color change or deformation;
- Do not wash water-proof clothes or products (such as ski suit, rain coat and curtain, etc.)

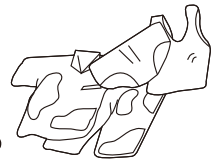

Operate Washing Machine

■ Detergent dispensing

There are two ways to dispense detergent according to different machine models:

Use of detergent (Auto add) _____

- You can add detergent to box ① before washing. Detergent can be dispensed to the drum according to clothes weight. One time of manual add, many times of smart, precise and auto dispensing;
- The max detergent volume is about 1.2 L;
- Wipe the dispenser cover and other accessories after adding detergent.

Use of detergent / softener (Manual add) _____

- Please press combination button to turn off this function (Icon out) if you want to use detergent or softener;
- Select foam-free or low-foam detergent which is suitable for machine wash;
- Put detergent with one time's dosage according to direction for use;
- Excessive detergent will produce a mass of foam and spill over, affecting dissolution of detergent and bringing difficulties to rinse.

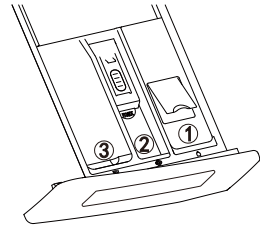

- ① Detergent box: liquid detergent
- ② Softener box: liquid softener
- ③ Detergent box: powder or liquid detergent.

■ Use of detergent / softener (General models)

- Pull out the detergent drawer.
 - Add detergent for main wash into compartment II.
- (option1:detergent that is solid; option2:detergent that is liquid.)
- Add fabric softener into compartment .
 - Please choose suitable type of detergent for the various washing temperature to get the best washing effect with less water and energy consumption.
 - The amount of detergent/softener used should be added only once at a time. Please refer to the manufacturer's instructions for the dosage of detergent/softener.
 - Excessive detergent will produce a lot of foam, easy to overflow, and will affect its dissolution, resulting in rinsing difficulties.

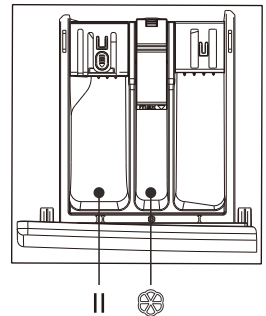

NOTE

1. Operate "Quick 15" completely for the first time of adding detergent and using auto dispensing function, in order to clean pipeline and the drum;
2. A little detergent will flow into water box when drawing the case, this is normal. Try not repeatedly opening and closing the case in case of detergent loss;
3. Softener dosage refers to direction for use, excessive dosage may damage artificial fiber;
4. The highest level of detergent and softener should not exceed MAX line in detergent case;
5. Thick softener or bleach liquid should be diluted before putting into detergent case;
6. Use auto-dispensing function when the drawer is correctly closed.

Operate Washing Machine

■ Washing steps

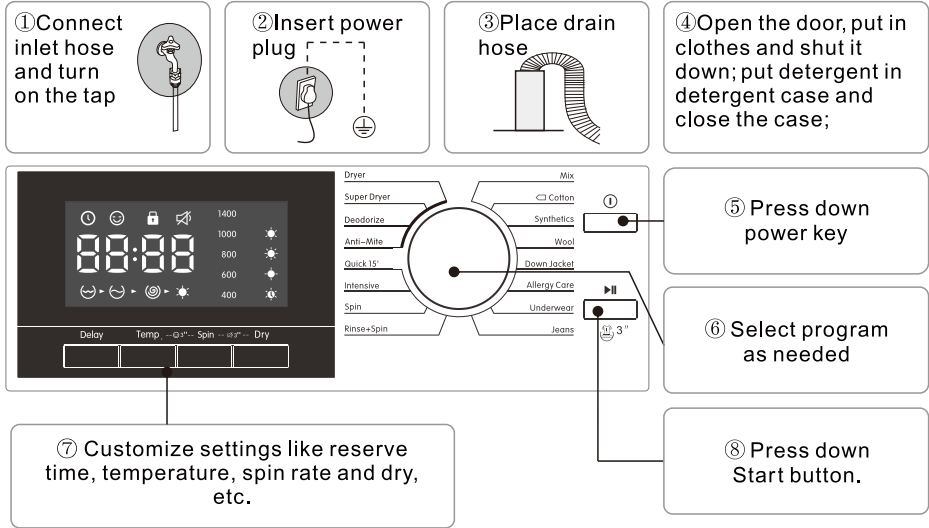

■ Control panel

Below is a simple example of the control panel section, actual effect is subject to actual machine model:

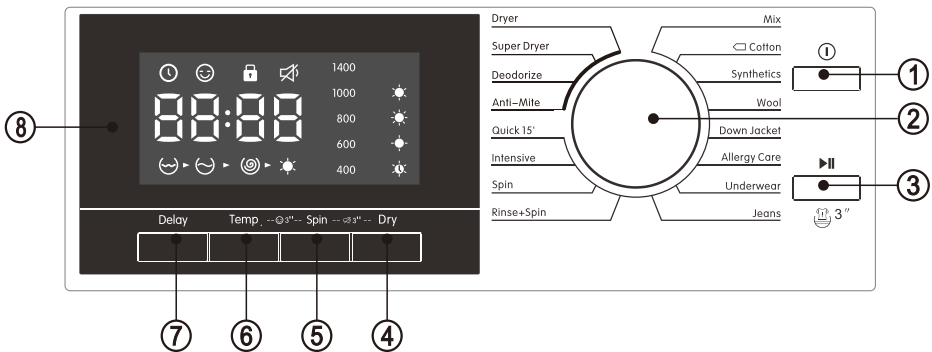

① Power Switch

- Press “Power” to switch on; press again to switch off;
- No operation within 10 minutes after power on, the machine will automatically power off.

② Program Knob

- Select needed program by rotating this knob;
- Current pointed location is default program when switching on.

Operate Washing Machine

③ Start/Pause Button

- Press this button to start or hold the machine; the lamp flashes during operation and stops during Hold state;
- Long press this button for three seconds to unlock the door to add clothes (note: for PTC lock series washing machine, please wait for Lock icon to disappear < about 2~3 mins > and then open the door!);
- If you want to add clothes during washing, please pay attention to the water level and temperature in the drum. Do not open the door when water level or temperature is too high;
- Nothing operated when pressing this button during Dry.

④ Dry

- Press this button to enter “Dry” function;
- Continue pressing this button to switch among “Standard”, “Heavy”, “Damp”, “Timing” and no Dry;
- Not all washing program can set dry functions due to different settings of control panel program.

 “Standard” – Dry program for general clothes;

 “Heavy” – You can directly wear clothes after Dry program;

 “Damp” – You need to dry clothes in the air after Dry program;

 “Timing” – Set Dry time as actually needed.

Mute

- Press “Dry” and “Spin” simultaneously for three seconds after switching on to turn on or off Mute function;
- There is no sound pressing other keys when this function is on.

⑤ Spin

- Continuously adjustable, the Spin rate is switching between 0~1400 for each pressing of the button;
- The max Spin rate is different in different programs.

Operate Washing Machine

Child-Lock

- Press “Temp.” and “Spin” simultaneously for three seconds during operation to turn on or off child-lock (when the water level is too high, please open the door when it decreases below safety limit);
- Other keys are invalid when this function is on;
- Child-lock is automatically off after the program is finished.

⑥ Temp.

- Continuously adjustable, the temperature is switching between null\20\30\40\60\95°C for each pressing of the button;
- The max temperature is different in different programs.

⑦ Delay

- Reservation time refers to the time from current to the end of operation;
- E.g.: 3h reservation means the program will be completely finished in 3 hours;
- You can turn off this function by pressing this key after 24h reservation or pressing down power switch to restart the machine.

⑧ Display

- It displays washing temperature (not displayed if not heated), rpm, time left (reserved time), washing course and dry time of selected program;
- See corresponding icons in Display Introduction.

Operate Washing Machine

■ Table of Washing Procedures

Washing Program Guide						
Program	Applicable clothes	Temp. Range (°C; - = cold)	Speed Range (r/min; 0=no spin)	Suggest that Weight(kg)		Dry option (Selectable)
				Rinse	Dry	
Mix	For mixed cotton and fiber clothes	--~40	0~1000	4	2.5	✓
☐ Cotton	For cotton clothes	--~Max	0~Max	8	5	✓
Synthetics	For synthetics clothes	--~60	0~800	4	2.5	✓
Wool	For woollen clothes	--~40	0~600	2	/	✗
Down Jacket	For feather clothes	--~40	0~800	3	2	✓
Allergy Care	For baby clothes	--~60	0~Max	4	2.5	✓
Underwear	For underwear	--~40	0~1000	3	2	✓
Jeans	For jeans	--~40	0~Max	6	3	✓
Rinse + Spin	For rinse and needed dewater clothes	--	0~Max	8	5	✓
Spin	For clothes only need dewater	--	0~Max	8	5	✓
Intensive	For heavily soiled items.	--~60	0~Max	8	5	✓
Quick 15'	For clothes with slight dirt, summer clothes or new clothes	--	0~1000	2	2	✓
Anti-Mite	For pest removal needed clothes	--	--	/	3	✓
Deodorize	For smell removal needed clothes	--	--	/	3	✓
Super Dryer	For common blending or polyster clothes	--	Max	0.5	0.5	✓
Dryer	For common clothes	--	0~Max	/	5	✓

NOTE

- Do not add powder detergent if the liquid detergent is not used out, otherwise it may cause foam spillover and wash difficulties due to excessive detergent;
- The washing time and effect of each program can be well controlled for clothes with slight dirt; add more detergent, take out some clothes or select program with longer operation time (Intensive, Cotton, etc.) if the clothes are too dirty.
- Some programs have cloth weight aware function and display "--" in timing area and then display time in 2~3 minutes after weighing;
- This machine has eccentric protection function to distribute and disperse clothes, so actual washing time is prolonged, this is normal;
- Do not touch the machine during Dry program in case of scald!(Suitable for dryers)

Operate Washing Machine

■ Precautions for dry function









Textile not suitable for drying

- Textile with No Dry label;
- Textile with wool and cashmere, in case of shrinkage;
- Fine textile (like silk), in case of crinkling;
- Textile with polymer rubber or similar materials;
- Textile processed by flammable solvent (like detergent and oil), in case of explosion;
- Dripping clothes will cost electricity and time and has bad drying effect.

⚠ Precautions for drying

- The weight of drying clothes must exceed the max rated drying capacity when using drying function, otherwise it may cause bad drying result;
- Bad drying result may be caused due to unsmooth water inlet and low water pressure;
- Divide drying clothes into batches if its weight exceeds the max rated drying capacity;
- Confirm if the clothes are suitable for drying, do not mix-drying clothes with different materials;
- Dry clothes made from special materials (such as cotton/fabric/down jacket/ underwear etc.) after select according washing program;
- Select according max spin rate of hand-washed clothes to improve drying performance and shorten drying time;
- Auto dewatering program will be proceeded when drying program starts, displaying time varies from clothes distribution; proper adding and reducing clothes can improve drying performance;
- The left drying time is approximate time, it may be shortened or prolonged according to clothes with different materials or drying degrees;
- The clothes may shrink or deforms according to different materials and constituents of the clothes after drying;
- Do not touch or open the door during drying in case of scald;
- Open the door after drying, take out the clothes (especially clothes with metal zips) before they are cooled in case of scald;
- Drying time refers to selected time or auto awareness time by program;
- The machine dries clothes based on the principle of condensation; It needs to inlet or drain water repeatedly so to improve drying performance. It does not belong to machine failure!

Approximate textile weight reference (dried)

 Underwear (Cotton, about 50g)	 Towel (Cotton, about 70g)	 T shirt (Cotton, about 150g)	 Shirt (Blending, about 200g)
 Socks (Blending, about 50g)	 Diaper (about 100g)	 Long-sleeve underwear (Cotton, about 150g)	 Work clothes (about 600g)

Operate Washing Machine

Common textile drying guide

Recommended Drying Program for Common Textile				
Textile type	Recommended washing program	Recommended drying program	Recommended drying Qty	Tips
Down Jacket	Down Jacket	Standard	1pcs	One down jacket + cold tumble dry, to keep it fluffy and smooth
Sweater and silk	Wool	-	-	The textile is fragile under high temp, do not dry.
Bedding	Cotton	Heavy	≤ 2pcs	The textile is easy to be twisted, this can make it completely dry.
Shirt	Quick 15'	Damp	≤ 4pcs	Airing to keep it damp for ironing
Thermal underwear	Underwear	Heavy	≤ 3pcs	The textile is thick, heavy drying can make it completely dry.
Underwear, sleepwear	Underwear	Standard	≤ 5pcs	The drying effect is the best with under qty.
Outerwear(spring and autumn)	Cotton	Standard	≤ 5pcs	The drying effect is the best with under qty.
Outerwear (winter)	Cotton	Heavy	≤ 2pcs	The textile is thick, heavy drying can make it completely dry.
Kid	Allergy Care	Standard	4~10pcs	The drying effect is the best with under qty.
Sports	Synthetics	Standard	≤ 5pcs	The textile is fragile under high temp. Use cold dry.
Towel, bath towel	Cotton	Standard	4~8pcs	The drying effect is the best with under qty.
Jeans	Jeans	Standard	4~10pcs	The drying effect is the best with under qty.
T shirt	Cotton	Standard	4~15pcs	The drying effect is the best with under qty.

NOTE

It costs about 40 minutes to wash two business shirts or clothes within 0.5 kg in Super Dryer program. With the increase of clothes weight, the machine will automatically adjust drying time to ensure drying result. The program time is increased accordingly, which is not a machine failure!

Operate Washing Machine

■ Display Introduction

Below is a simple example of the display panel ,actual effect is subject to actual machine model:

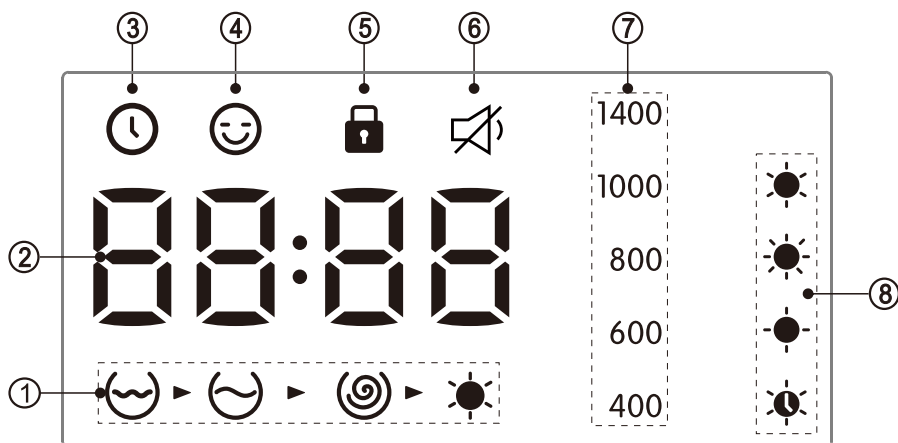

① Washing process

From left to right in order: Wash, Rinse, Spin and Dry. Which icon flashes, which function runs.

③ Reservation

You have started reservation function if this icon flashes. The washing programs are completely finished if reservation time runs out.

④ Child Lock

The program is locked when this icon is on. Any operation to change program is invalid.

⑤ Door Lock

This icon is off when the door is unclosed or abnormally locked.

⑥ Mute

The icon for common dispensing model is "🔇". When it is on, the Mute function is on; other keys will be silent when pressing down.

⑦ Dewatering spin rate

The area displays Max spin rate. The icon is flashing if the program is selected; different Max spin rates can be selected according to different default dewatering spin rate.

⑧ Drying method

This area displays Drying method. The method is selected when its icon is always on.

NOTE: The display configuration may differ from the machine model configuration.

Operate Washing Machine

■ Introduction of Other Functions

Unlock of emergency door (not applicable in some models)

- If you want to take out the clothes when there is a long-time power cut, make sure the water level in the drum is below the safe level, the temperature is under 40°C, and the inner drum is does not rotate, then detach the drain hose and lower it, replace the hose after water runs out;
- Open the drain pump cover at the bottom right of the front side, pull down the rod lightly, when hearing a light sound then open the door and take out or put in the clothes;
- Replace drain pump cover;
- This method can only be used in emergency.

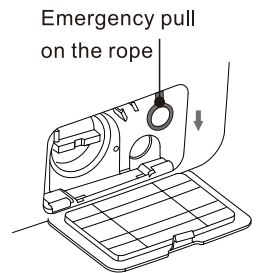

Auto Dispensing (not applicable in some models)

- This machine can dispense the laundry detergent automatically. When you want to use the powder detergent by yourself, please turn off the combination button to stop this function;
- When you start the machine, if the indicator light shows full, it means the detergent is abundant; when the washing finishes, if there is only one bar of the light left, and it shows “□□□□” for the service time, it means the detergent is running out, then you need to add the detergent.
- Before the washing, you can put the detergent in the detergent case, then the machine will dispense the detergent according to the weight of the clothes in the process of washing automatically.
- Please find the process table for further information of the default state for this function.

Resume Function

- This machine has the resume function in case of power-down. If there is a power failure or plug loose in the process of machine, the machine can remember the working status and resume work when the power is restored.

Memory Function (not applicable in some models)

- This machine can remember the latest working process automatically. When you turn on the machine again, the machine remembers the washing process and the settings you made last time (it means the whole working process of the latest washing will be selected by default when the machine starts)

Cloth Weigh Awareness

- In the beginning of the washing, the machine will estimate the weight of the clothes and dispense the detergent automatically (on condition that there is enough detergent in the case), then decide the amount of the water accordingly to achieve the goal of saving water.

Operate Washing Machine

Unbalance Protection

- When the machine is ready to spin, The washer may take a few time to balance clothes due to great unbalance.
- If clothes is still unbalance in the drum after that, the spinning speed can be slow down to avoid great vibration.
- If clothes in drum is too less, the machine may not to spin due to the unbalance protection, then you should add more clothes in the machine to make it to spin.

Sprinkling (not applicable in some models)

- This machine adopts detergent auto dispensing technology; water will flow out from the detergent case to delivery detergent into inner drum. It will also spray water on the glass of observation window, which has better effect of cleaning the foam and stains on the clothed and window. This will make washing process cleaner and construct a high efficient, water-saved and clean washing environment!

Drum lamp (not applicable in some models)

- At the beginning of the program, at the end of the program and at the pause of the washing state, the lamp of the washing machine cylinder will be lit. You can observe the situation of the clothes in the washing machine and feel the fun of smart laundry.

Note: Due to the product model upgrade, the function configuration may be different from this description, please take the actual model function as the standard!

Troubleshooting

Common failure analysis and elimination method

It may not be failure when below circumstances occur. Please check and confirm according to below list before sending for maintenance. It is confirmed to be a failure, please contact our after-sales service department instead of repairing by yourself. Please unplug power cord and turn off the tap before checking to ensure safety.

A little water left in the drain hose and the machine for first time of use



Normal, water left in delivery inspection.

The machine does not operate



Is electricity cut off or power abnormal? power cord correctly plugged into the socket? power fuse or current breaker in good condition? power switch pressed down? water tap turned on? Is reservation set? "Start/Pause" key pressed down?

No operation of keys



Is "Child-lock" function set? Press "Start/Pause" key before selecting other functions after the machine is started.

Water leakage of tape



Is the tap shape appropriate? inlet hose connector installed well? water tap damaged?

Abnormal sound



Is the machine tilted and shaking? Are there coins, zips or other foreign matters? Is it caused by buttons or zips?

No water inflows or inflows too slowly



Is the tap turned on? water supply cut off? Inlet valve blocked? (clean inlet valve) water tap and inlet hose freezed? preservation function selected? "Start/Pause" key pressed? Bent of inlet hose? Water pressure over low?

Water outflows while inflowing



Is installation height of drain hose lower than 65 cm? Is drain hose mouth soaked in water?

Bad washing effect



Is detergent dosage appropriate? Is selected program correct?

The machine washes slowly



Does clothes volume exceed standard washing capacity?

The machine stops during operation



Is electricity or water supply suddenly cut off? Is "Start/Pause" key pressed down?

The machine does not dewater



It takes a while to dewater after setting dewatering time. Are clothes twisted or knotted?

Noisy, vibrating and displaced while dewatering



Are transit bolts all removed? Is the machine placed stable? (adjust supporting legs to make it stable) Are clothes twisted or knotted? Does the machine crash other objects? Is there foreign matters dropped in?

Bad dewatering effect



Dewatering effect varies from different clothes.

No water outflows or outflows too slowly



Is the drain hose bent, blocked or freezed? Is the installation height of drain hose 100cm higher than the ground? Is the filter blocked?

Reservation timeout but washing unfinished



Offset of clothes during washing; Bad inlet and outlet conditions prolongs washing time.

























Troubleshooting

Display code analysis (Please refer to the actually purchased model for fault display here. Different models have different fault displays)

Display Code	Code Analysis	Elimination Method
E1	Inflow timeout	Check if the tap is turned on, water pressure is too low or water failure; if the failure still exists, please contact us for maintenance.
E2	Outflow timeout	Clean drain pump filter, check if the drain hose is blocked; if the failure still exists, please contact us for maintenance.
E3	Lock failure	Reclose the door; if the failure still exists, please contact us for maintenance.
E4	Spillover alert	Continue running after auto draining water to washing water level; if the failure still exists, please contact us for maintenance.
E5	Motor failure	Please contact us for maintenance
E6	Heating pipe failure	Please contact us for maintenance
E7	Thermal sensor failure	Please contact us for maintenance
E8	Unmatched software/hardware on mainboard and frequency inverting plate	Please contact us for maintenance
E9	Frequency inverting plate communication failure	Please contact us for maintenance
E10	Frequency inverting plate failure	Please contact us for maintenance
E13	Drying fan failure	Please contact us for maintenance
E14	Drying heater failure	Please contact us for maintenance
E15	Thermal sensor in drying air outlet failure	Please contact us for maintenance
E16	Thermal sensor in drying air inlet failure	Please contact us for maintenance
E91	Drying module communication failure	Please contact us for maintenance
nSP	Dewatering failure in drying starting stage, operation holds and alarms	Overload eccentric force, please scatter clothes or add some clothes; restart Dry program after adding clothes; if the failure still exists, please contact us for maintenance.
EP	The procedure running is not corresponded to the cycle that the knob points.	Turn the cycle selector to the cycle corresponded to the procedure working on.

Appendix

■ Fabric Care Lable

	Resistant material		Can be ironed at 100°C max
	Delicate fabric		Do not iron
	Item may be washed at 90°C		Can be dry cleaned using any solvent
	Item may be washed at 60°C		Dry clean with perchloride, lighter fuel, pure alcohol or R113 only
	Item may be washed at 40°C		Dry clean with aviation fuel, pure alcohol or R113 only
	Item may be washed at 30°C		Do not dry clean
	Item may be hand washed		Dry flat
	Dry clean only		Can be hung to dry
	Can be bleached in cold water		Dry on clothes hanger
	Do not bleach		Tumble dry, normal heat
	Can be ironed at 200°C max		Tumble dry, reduced heat
	Can be ironed at 150°C max		Do not tumble dry

■ Electrical Warning

To avoid fire, electrical shock and other accidents, please remember the following reminding:

- Only the voltage indicated in power label can be used. If you are not clear of the voltage at home, please contact the local power bureau.
- When you are using the heating function, the maximum current through the washing machine will reach 10A. Therefore, please make sure the power supply units(current, voltage and cable) can meet the normal laod requirements for the machine.
- Protect the power cord properly. Power cord shall be fixed well so that it will not trip the people or other things and be damaged. Special attention shall bepaid to the plug location.
- Do not make the wall-mounted socket overloaded or cable extended. Over loading of the wiring may cause fire or electrical shock. Do not pull out power plug with wet hand.
- To ensure your safety, power plug shall be inserted into an earthed socket. Carefully check and ensure that your socket is properly and reliably earthed.

Appendix

■ Protecting the environment

- The washer is manufactured by recyclable materials. If you decide to dispose of this washer, please observe the local waste disposal regulations. Cut off the power cord so that the washer cannot be connected to power. Remove the door so that small animals and children cannot get trapped inside the washer.
- Do not exceed the detergent quantities recommended in the detergent manufactures' instruction.
- Use stain removal products and blesches before the wash cycle only when strictly necessary.
- Save water and electricity by only washing full loads(the exact amount depends upon the program used).
- Correct Disposal of this Product



This marking indicates that this product should not be disposed with other household wastes throughout the EU. To prevent possible harm to the environment or human health from uncontrolled waste disposal, recycle it responsibly to promote the sustainable reuse of material resources. To return your used device, please use the return and collection systems or contact the retailer where the product was purchased. They can take this product for environmental safe recycling.

Products Fiche

Brand: Duos
Model: DWD85
Rated capacity: 8.0kg
Rated drying capacity: 5.0kg

AS/NZS 2442.1:1996+A1-A4 and AS/NZD

2442.2:2000+A1-A2;

AS/NZS 2040.1:2005 and AS/NZS

2040.2:2005;

AS/NZS 6400: 2016

Standard Programme	Load	Energy consumption	Water consumption	Program time
Washing stage: Cotton 60°C	8.0kg	1.23kWh	81L	234min
Drying stage: Dryer	5.0kg	3.20kWh	37L	165min

The duration of the left-on mode is: 10min

Power consumption of off-mode: 0.5W

Power consumption of left-on mode: 1.0W

Airborne acoustical noise (washing): 62dB

Airborne acoustical noise (spinning): 75dB

Airborne acoustical noise (drying): 70dB

Note:

- The actual parameters will depend on how the appliance is used, and maybe different with the parameters in above mentioned table.
- The airborne acoustical noise emissions during washing / spinning / drying for the standard 60°C cotton programme at full load.

